

LIMITS OF DISTURBANCE

INSTALL TEMP. PUMP INLET USING SANDBAGS

GROUT AND REPOINT EX. BOULDER WALL & REPLACE OR FILLED THE GAP WITH STONE WHERE NECESSARY

INSTALL 112" X 71" CORRUGATED METAL PIPE-ARCH GROUT FILLED SLIPLINING & MATCH EX. LENGTH

EX. 117" X 79" CORRUGATED METAL PIPE-ARCH CULVERT TO REMAIN & BE MODIFIED AS NECESSARY BY MANUFACTURER REQUIREMENTS FOR SLIP LINING

SANDBAGS AND TURBIDITY CURTAIN TO PROTECT GROUT AREA OF CULVERT

GROUT AND REPOINT EX. STONE WALL

DISCHARGE AREA

LIMITS OF DISTURBANCE

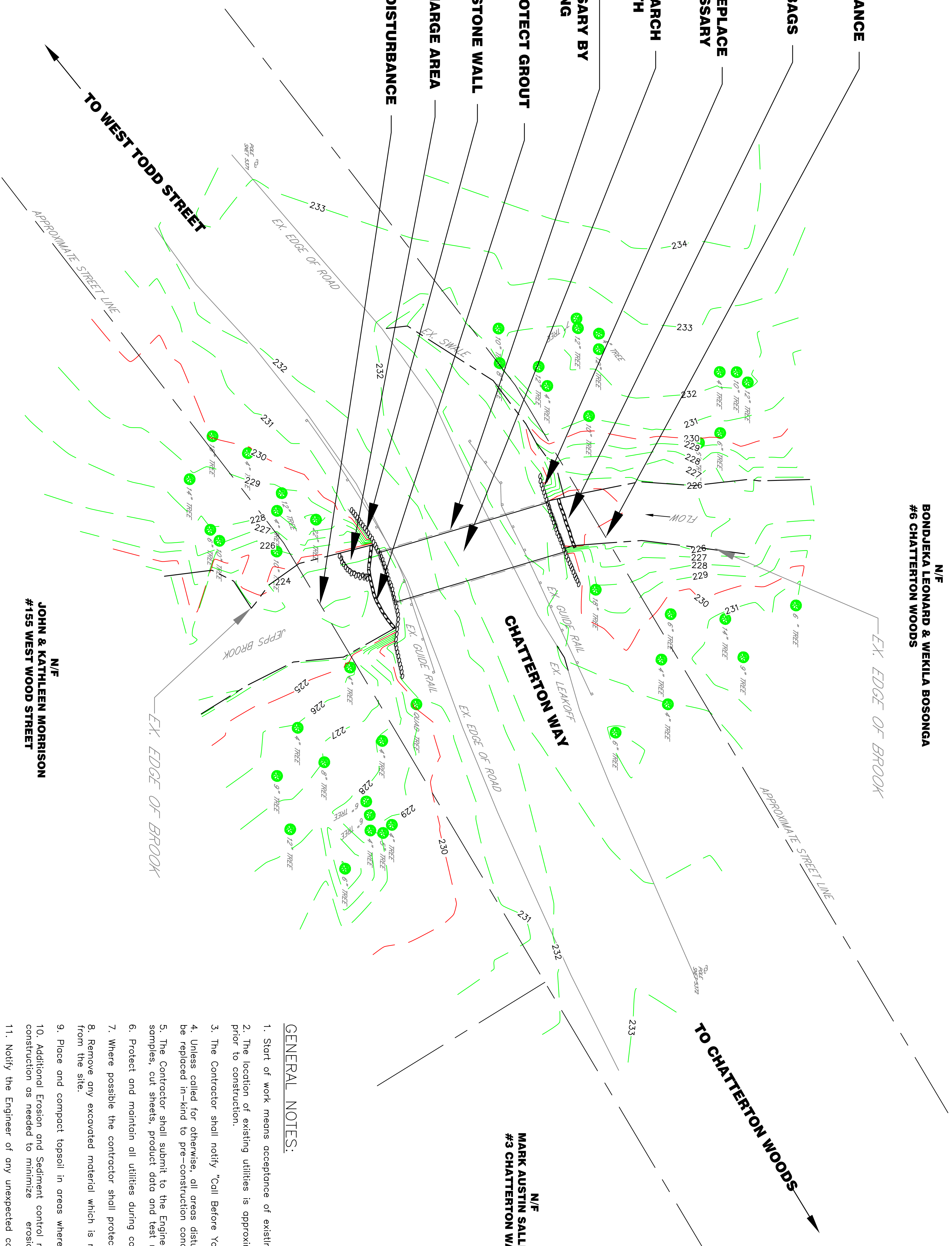

N/F
BONDJEKA LEONARD & WEKILA BOSONGA
#6 CHATTERTON WOODS

N/F
JOHN & KATHLEEN MORRISON
#155 WEST WOOD STREET

N/F
MARK AUSTIN SALLER & MELINDA LAVELLE
#3 CHATTERTON WAY

GENERAL NOTES:

1. Start of work means acceptance of existing conditions.
2. The location of existing utilities is approximate only and should be verified prior to construction.
3. The Contractor shall notify "Call Before You Dig" at 1-800-922-4455.
4. Unless called for otherwise, all areas disturbed during construction shall be replaced in-kind to pre-construction condition.
5. The Contractor shall submit to the Engineer for approval any shop drawings, samples, cut sheets, product data and test reports as he may request.
6. Protect and maintain all utilities during construction.
7. Where possible the contractor shall protect existing trees.
8. Remove any excavated material which is not incorporated into the site work, from the site.
9. Place and compact topsoil in areas where seeding is scheduled.
10. Additional Erosion and Sediment control measures shall be taken during construction as needed to minimize erosion and prevent sedimentation migration.
11. Notify the Engineer of any unexpected conditions.
12. The Contractor shall be responsible for the maintenance and repair of sedimentation and erosion controls until all activities have been completed and the area is stabilized.
13. Refer all questions to the Engineering Department, Town of Hamden, 2750 Dixwell Avenue Telephone: 287-7040 Fax: 287-7045.

MAP REFERENCE:

1. SUBDIVISION/TOPOGRAPHIC MAP, "CHATTERTON WOODS", WEST TODD STREET - CHATTERTON WAY, HAMDEN, CT, DATED: APRIL 14, 1987, SCALE: 1" = 50', PREPARED BY SAVARESE ASSOCIATES, P.C., HAMDEN, CT. MAP #788 HAMDEN TOWN CLERKS OFFICE.

DRAWN BY: R.K.L	CHKD BY: S.A.M	REV
DATE: 03/14/2019	DATE: 03/14/2019	
SCALE: 1"=10'	JOB # 18056	
PROJ: CHATTERTON WAY CULVERT REPAIR	DWG NO. SP-1	

CHATTERTON WAY CULVERT REPAIR
HAMDEN, CONNECTICUT

TOWN OF HAMDEN
ENGINEERING DEPARTMENT
2750 DIXWELL AVE
HAMDEN, CONNECTICUT 06518
(203) 287-7040 FAX (203) 287-7045

